

Architect is not responsible for any dimensions scaled from drawings. Dimensions noted take precedence.



Addition for:
GENOA CHURCH
 Project Address:
 7562 Lewis Center Rd., Westerville, OH 43082

DRAWING DATE

<input type="checkbox"/> Preliminary Check Set	17 JAN 19
<input checked="" type="checkbox"/> Preliminary Check Set	11 MAR 19
<input type="checkbox"/> Preliminary Check Set	09 APR 19
<input type="checkbox"/> Permit Set	15 MAY 19
<input type="checkbox"/> Bid Set	22 MAY 19

REVISIONS

SITE CONCEPT PLAN

OF .. SHEETS

218328

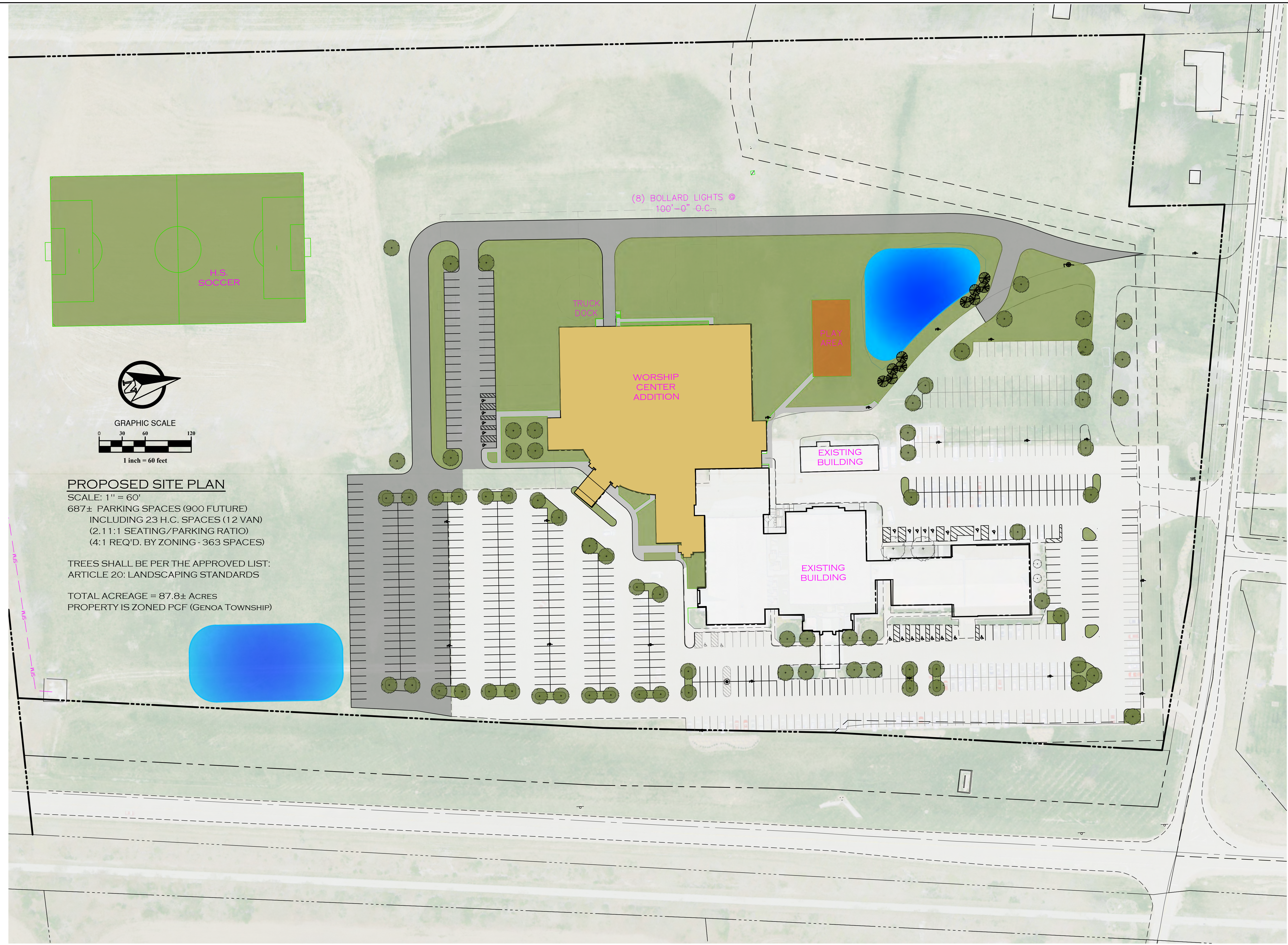

PROPOSED SITE PLAN
 SCALE: 1" = 60'
 687± PARKING SPACES (900 FUTURE)
 INCLUDING 23 H.C. SPACES (12 VAN)
 (2.11:1 SEATING/PARKING RATIO)
 (4:1 REQ'D. BY ZONING - 363 SPACES)

TREES SHALL BE PER THE APPROVED LIST:
 ARTICLE 20: LANDSCAPING STANDARDS

TOTAL ACREAGE = 87.8± ACRES
 PROPERTY IS ZONED PCF (GENOA TOWNSHIP)